

Ventilated Type HEAVY DUTY

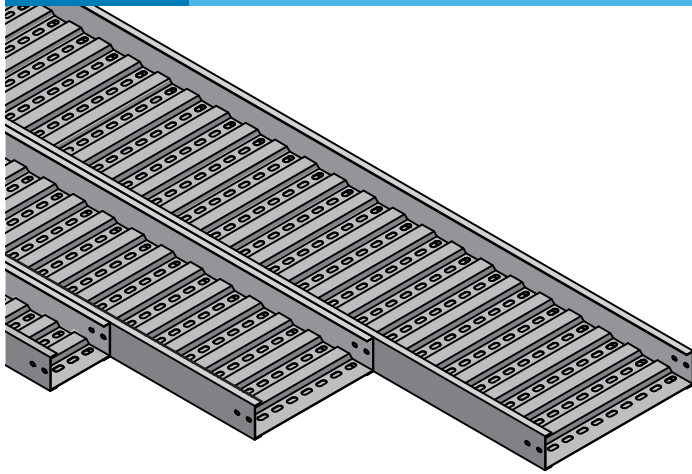

CABLE TRAY



Description / Application Heavy Duty VENTILATED TROUGH CABLE TRAY TYPE / General Indoor & Outdoor

Material Selection Hot Roll Mild Steel / Stainless / Electro Galvanized

Deformation Standard NEMA VE-01 Certified

Finishing Standard Epoxy Powder Coating-ASTM D687
Hot Dip Galvanized-ASTM A123

Length (mm.) 3000

Height (mm.) 100 150

Thickness (mm.) 2.0/1.6 2.0/2.0

Side Rail Profile U-Shape in

Assembly Welding

Detail :

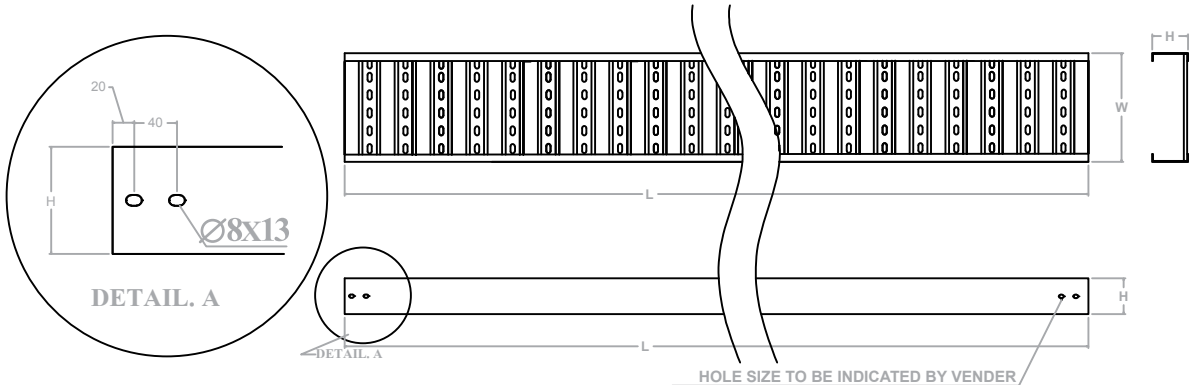

CODE NO. EPOXY POWDER COATING	CODE NO. HOT DIP GALVANIZED	CABLE TRAY SIZE W x H x L	WEIGHT/KG/EA		
			TRAY T = 2.0 MM.	COVER	
				T = 1.6 MM.	T = 2.0 MM.
VP 01	VH 01	100 X 100 X 3000	17.66	5.20	6.50
VP 02	VH 02	200 X 100 X 3000	21.65	8.97	11.21
VP 03	VH 03	300 X 100 X 3000	25.64	12.74	15.92
VP 04	VH 04	400 X 100 X 3000	29.64	16.50	20.63
VP 05	VH 05	500 X 100 X 3000	33.63	20.27	25.34
VP 06	VH 06	600 X 100 X 3000	37.62	24.01	30.05
VP 07	VH 07	700 X 100 X 3000	41.62	27.81	34.76
VP 08	VH 08	800 X 100 X 3000	45.61	31.58	39.35
VP 09	VH 09	900 X 100 X 3000	49.61	35.34	44.18
VP 10	VH 10	1000 X 100 X 3000	53.60	39.11	48.89
VP 12	VH 12	1200 X 100 X 3000	61.62	46.65	58.31

*L = Ladder, P = Epoxy Powder Coating, H = Hot Dip Galvanized

Ventilated Type HEAVY DUTY



FITTINGS

HORIZONTAL CROSS

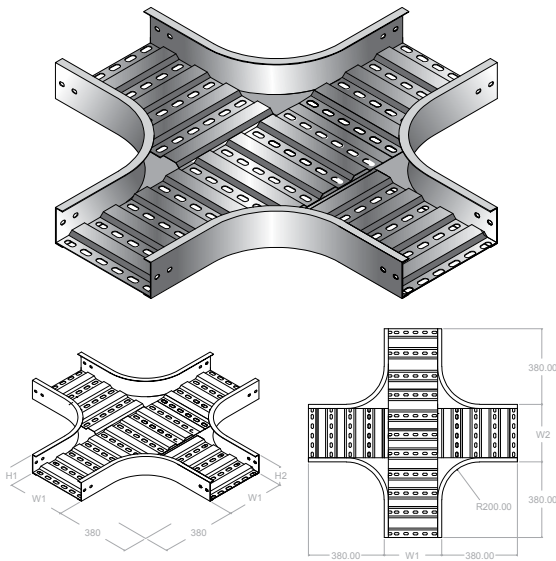

CODE NO. EPOXY POWDER COATING	CODE NO. HOT DIP GALVANIZED	CABLE TRAY SIZE W x H	WEIGHT/KG/EA		
			TRAY	COVER	
			T = 2.0/1.6 MM.	T = 1.6 MM.	T = 2.0 MM.
HX-VP 01	HX-VH 01	100X100	8.37	9.92	12.40
HX-VP 02	HX-VH 02	200X100	11.93	12.56	15.70
HX-VP 03	HX-VH 03	300X100	14.99	15.20	19.00
HX-VP 04	HX-VH 04	400X100	18.32	18.09	22.61
HX-VP 05	HX-VH 05	500X100	21.91	21.23	26.53
HX-VP 06	HX-VH 06	600X100	25.77	24.62	30.77
HX-VP 07	HX-VH 07	700X100	29.90	28.26	35.33
HX-VP 08	HX-VH 08	800X100	34.29	32.15	40.19
HX-VP 09	HX-VH 09	900X100	38.95	36.30	45.37
HX-VP 10	HX-VH 10	1000X100	43.88	40.69	50.87
HX-VP 12	HX-VH 12	1200X100	50.00	45.97	67.47

*L = Ladder, P = Epoxy Powder Coating, H = Hot Dip Galvanized

HORIZONTAL TEES

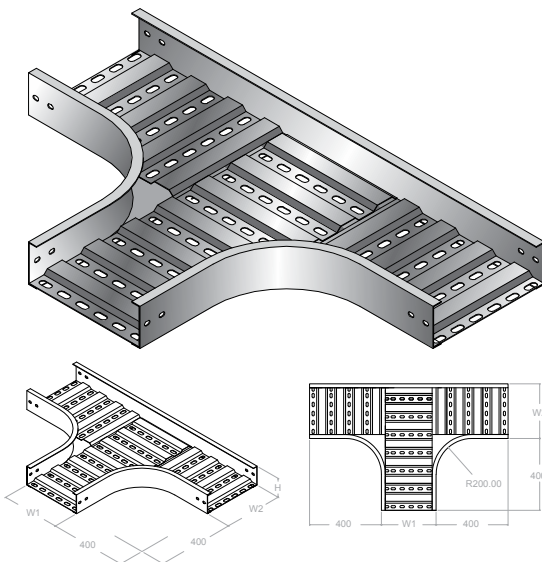

CODE NO. EPOXY POWDER COATING	CODE NO. HOT DIP GALVANIZED	CABLE TRAY SIZE W x H	WEIGHT/KG/EA		
			TRAY	COVER	
			T = 2.0/1.6 MM.	T = 1.6 MM.	T = 2.0 MM.
HT-VP 01	HT-VH 01	100X100	7.63	5.03	7.03
HT-VP 02	HT-VH 02	200X100	9.93	7.79	9.73
HT-VP 03	HT-VH 03	300X100	12.26	9.95	12.43
HT-VP 04	HT-VH 04	400X100	15.16	12.36	15.45
HT-VP 05	HT-VH 05	500X100	18.32	15.02	18.78
HT-VP 06	HT-VH 06	600X100	21.76	17.94	22.42
HT-VP 07	HT-VH 07	700X100	25.45	21.10	26.38
HT-VP 08	HT-VH 08	800X100	29.41	24.52	30.65
HT-VP 09	HT-VH 09	900X100	33.64	28.18	35.23
HT-VP 10	HT-VH 10	1000X100	38.13	32.10	40.13
HT-VP 12	HT-VH 12	1200X100	46.85	39.68	49.61

*L = Ladder, P = Epoxy Powder Coating, H = Hot Dip Galvanized

HORIZONTAL BEND

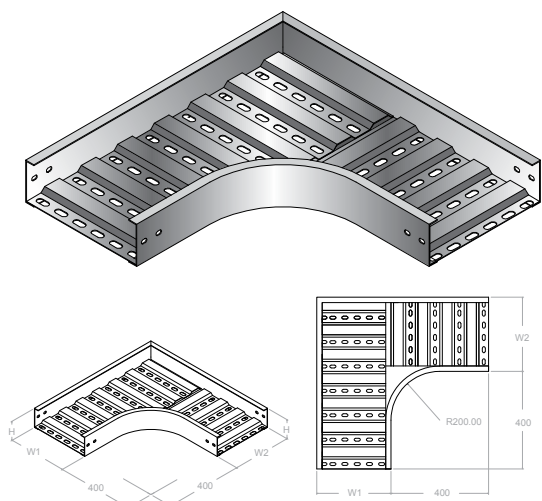

CODE NO. EPOXY POWDER COATING	CODE NO. HOT DIP GALVANIZED	CABLE TRAY SIZE W x H x L	WEIGHT/KG/EA		
			TRAY	COVER	
			T = 2.0 MM.	T = 1.6 MM.	T = 2.0 MM.
90HB-VP 01	90HB-VH 01	100X100	5.06	3.18	3.94
90HB-VP 02	90HB-VH 02	200X100	7.39	4.83	6.04
90HB-VP 03	90HB-VH 03	300X100	9.72	6.51	8.14
90HB-VP 04	90HB-VH 04	400X100	12.85	8.45	10.56
90HB-VP 05	90HB-VH 05	500X100	15.18	10.63	13.29
90HB-VP 06	90HB-VH 06	600X100	18.33	13.07	16.33
90HB-VP 07	90HB-VH 07	700X100	21.70	15.76	19.69
90HB-VP 08	90HB-VH 08	800X100	25.36	18.69	23.37
90HB-VP 09	90HB-VH 09	900X100	29.33	21.88	27.36
90HB-VP 10	90HB-VH 10	1000X100	33.50	25.33	31.66
90HB-VP 12	90HB-VH 12	1200X100	41.64	31.97	49.95

*L = Ladder, P = Epoxy Powder Coating, H = Hot Dip Galvanized

Ventilated Type HEAVY DUTY



FITTINGS

HORIZONTAL REDUCE

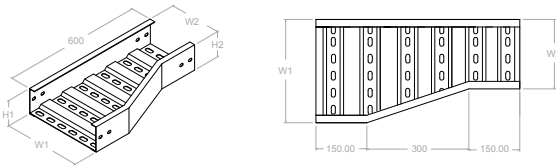
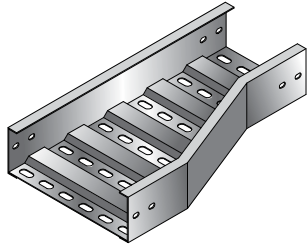

CODE NO. EPOXY POWDER COATING	CODE NO. HOT DIP GALVANIZED	CABLE TRAY SIZE W1 x W2 x H	WEIGHT/KG/EA		
			TRAY		COVER
			T = 2.0/1.6 MM.	T = 1.6 MM.	T = 2.0 MM.
HR-VP 02	HR-VH 02	200,W2 X 100	3.59	0.89	1.11
HR-VP 03	HR-VH 03	300,W2 X 100	4.33	1.58	1.97
HR-VP 04	HR-VH 04	400,W2 X 100	5.07	2.27	2.83
HR-VP 05	HR-VH 05	500,W2 X 100	5.80	2.96	3.70
HR-VP 06	HR-VH 06	600,W2 X 100	6.53	3.65	4.56
HR-VP 07	HR-VH 07	700,W2 X 100	7.26	4.34	5.42
HR-VP 08	HR-VH 08	800,W2 X 100	8.00	5.03	6.29
HR-VP 09	HR-VH 09	900,W2 X 100	8.73	5.72	7.15
HR-VP 10	HR-VH 10	1000,W2 X 100	9.46	6.41	8.01
HR-VP 12	HR-VH 12	1200,W2 X 100	10.92	7.79	9.73

*L = Ladder, P = Epoxy Powder Coating, H = Hot Dip Galvanized

VERTICAL INSIDE

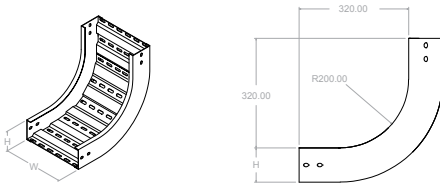
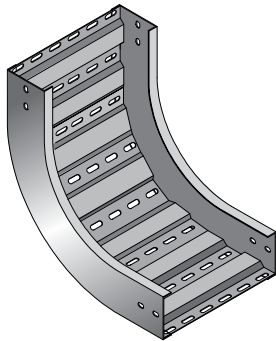

CODE NO. EPOXY POWDER COATING	CODE NO. HOT DIP GALVANIZED	CABLE TRAY SIZE W x H x L	WEIGHT/KG/EA		
			TRAY		COVER
			T = 2.0/1.6 MM.	T = 1.6 MM.	T = 2.0 MM.
90VI-VP 01	90VI-VH 01	100X100	4.22	1.14	1.42
90VI-VP 02	90VI-VH 02	200X100	5.15	2.01	2.51
90VI-VP 03	90VI-VH 03	300X100	6.08	2.88	3.60
90VI-VP 04	90VI-VH 04	400X100	7.00	3.75	4.69
90VI-VP 05	90VI-VH 05	500X100	7.93	4.63	5.78
90VI-VP 06	90VI-VH 06	600X100	8.85	5.50	6.87
90VI-VP 07	90VI-VH 07	700X100	9.78	6.37	7.97
90VI-VP 08	90VI-VH 08	800X100	10.70	7.25	9.06
90VI-VP 09	90VI-VH 09	900X100	11.63	8.12	10.15
90VI-VP 10	90VI-VH 10	1000X100	12.55	8.99	11.24
90VI-VP 12	90VI-VH 12	1200X100	14.44	10.73	13.42

*L = Ladder, P = Epoxy Powder Coating, H = Hot Dip Galvanized

VERTICAL OUTSIDE

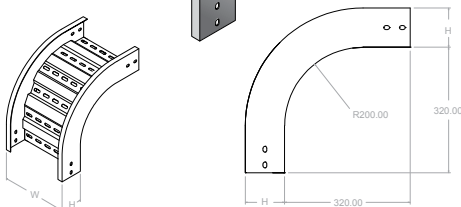
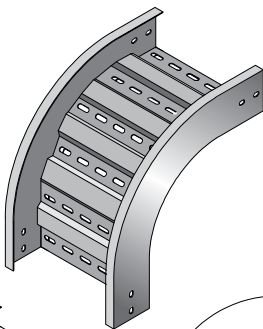

CODE NO. EPOXY POWDER COATING	CODE NO. HOT DIP GALVANIZED	CABLE TRAY SIZE W x H x L	WEIGHT/KG/EA		
			TRAY		COVER
			T = 2.0/1.6 MM.	T = 1.6 MM.	T = 2.0 MM.
90VO-VP 01	90VO-VH 01	100X100	4.22	1.14	1.42
90VO-VP 02	90VO-VH 02	200X100	5.15	2.01	2.51
90VO-VP 03	90VO-VH 03	300X100	6.08	2.88	3.60
90VO-VP 04	90VO-VH 04	400X100	7.00	3.75	4.69
90VO-VP 05	90VO-VH 05	500X100	7.93	4.63	5.78
90VO-VP 06	90VO-VH 06	600X100	8.85	5.50	6.87
90VO-VP 07	90VO-VH 07	700X100	9.78	6.37	7.97
90VO-VP 08	90VO-VH 08	800X100	10.70	7.25	9.06
90VO-VP 09	90VO-VH 09	900X100	11.63	8.12	10.15
90VO-VP 10	90VO-VH 10	1000X100	12.55	8.99	11.24
90VO-VP 12	90VO-VH 12	1200X100	14.44	10.73	13.42

*L = Ladder, P = Epoxy Powder Coating, H = Hot Dip Galvanized

Ventilated Type HEAVY DUTY



ACCESSOIRES

SPLICE PLATE (OUT)

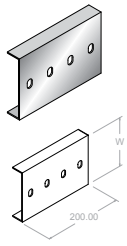

CODE NO. EPOXY POWDER COATING	SP-VP (OUT)
CODE NO. HOT DIP GALVANIZED	SP-VH (OUT)
THICKNESS MM.	2
WEIGHT KG.	0.52

SPLICE PLATE (IN)

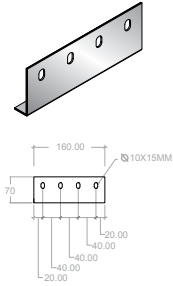

CODE NO. EPOXY POWDER COATING	SP-VP (IN)
CODE NO. HOT DIP GALVANIZED	SP-VH (IN)
THICKNESS MM.	2
WEIGHT KG.	1.05

VERTICAL ADJUSTTABLE

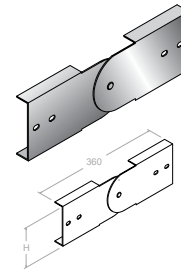

CODE NO. EPOXY POWDER COATING	VAJ-VP
CODE NO. HOT DIP GALVANIZED	VAJ-VH
THICKNESS MM.	2
WEIGHT KG.	1.12

HORIZONTAL ADJUSTTABLE

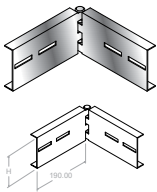

CODE NO. EPOXY POWDER COATING	H AJ-VP
CODE NO. HOT DIP GALVANIZED	H AJ-VH
THICKNESS MM.	2
WEIGHT KG.	1.2

END CAP

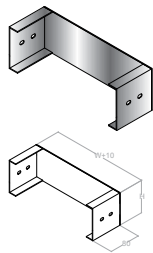

CODE NO. EPOXY POWDER COATING	EC-VP
CODE NO. HOT DIP GALVANIZED	EC-VH
THICKNESS MM.	2
WEIGHT KG.	0.2

FLANGE END

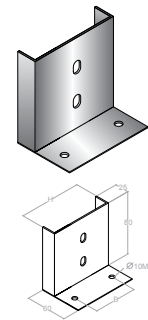

CODE NO. EPOXY POWDER COATING	FE-VP
CODE NO. HOT DIP GALVANIZED	FE-VH
THICKNESS MM.	2
WEIGHT KG.	0.6

COVER FOR VENTILATED TYPE (HEAVY DUTY)

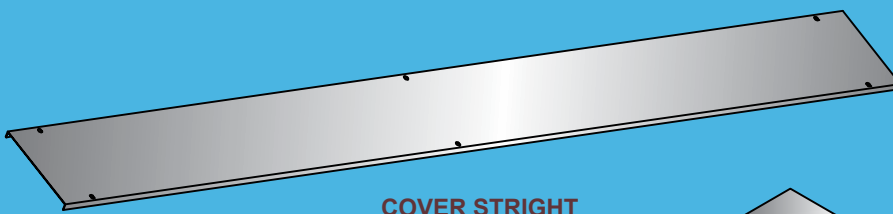

COVER STRIGHT

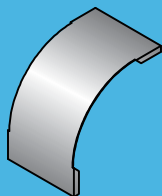

VERTICAL OUTSIDE

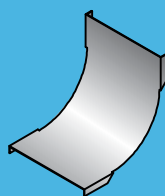

VERTICAL INSIDE

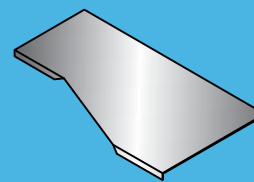

HORIZONTAL REDUCE
RIGHT HAND

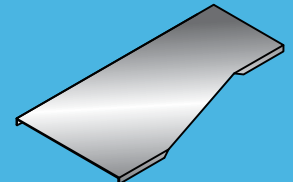

HORIZONTAL REDUCE
LEFT HAND



HORIZONTAL BEND

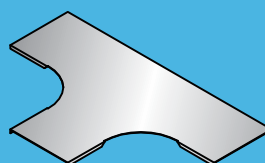

HORIZONTAL TEES

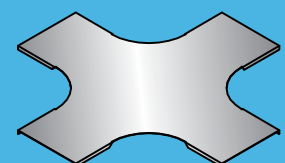

HORIZONTAL CROSS